



TWO-WIRE BUS APARTMENT SYSTEM
GF Audio Series



Aiphone Introduces a Two-Wire BUS Apartment System.

Aiphone introduces the simplest apartment entry intercom system available on the market. The GF system features a simple 2-wire BUS connection to all room stations throughout the system, enabling Simple and Quick system set-up. The GF audio system is the ideal communication solution for new and existing apartment applications.

Entrance station

Entrance Station is a vandal-proof zinc diecast panel with call buttons. Fully modular design with Speech Module and Call Switch Modules. Optional Address and Blank Panels are available.

1. Blank panel module is used for installing Door opening key switch or proximity access control system.
2. Entrance Station is weather-resistant, and Weathering Hood is also available.

Speech module

Comes complete with speaker & mic. for audio communication, and IN-USE LED to indicate the system is in use at another entrance station.

Directory cover

Directory employs easy-to-see translucent card, with backlighting for low light conditions, protected by polycarbonate cover.

Call Switch

The Call Switch Modules are available with 1 ~ 4 call buttons (GF-1P~ 4P). Include desired number of buttons on entrance station. Buttons are of fully protected zinc-diecast, same as front cover panel.

Simple and easy Installation and Programming

Just pick up an apartment phone and press a call button at entrance station.

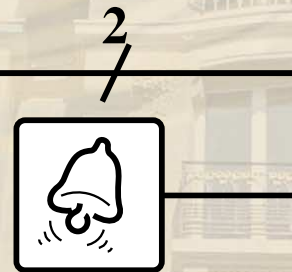

Residential doorbell
Once inside the building, a visitor presses a doorbell, ringing the Apartment Station with a different call tone than the one heard from the entrance station(s).

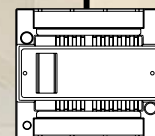
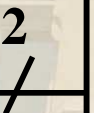

GF-BC
BUS Control Unit. Distributes two-wire BUS line, and provides a junction point within 5 meter distance, from which divided multiple BUS lines may be distributed.

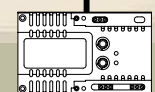

PS-24ME (or equivalent)
One 24V DC Power Supply powers an entire system, located within 5 meter of BUS Control Unit.

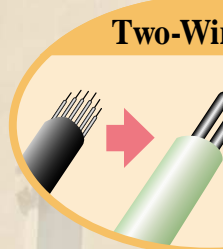

Apartment station

Apartment Station is a compact and slim design for single-gang wall mounting. Comes equipped with SERVICE, LIGHT & DOOR RELEASE buttons, and modular plug-in handset. Includes call tone cutout (w/indicator) and *DOCTORCALL.

* Program for doctor call with LIGHT button. Door releases automatically when called from Entrance Station.



SERVICE button

Button may activate a user-optional feature, such as turning on/off light at entry way to elevator, etc.

LIGHT button

While communicating with an Entrance Station, press LIGHT button, providing 1 sec. signal to have external light relay activated.

DOOR RELEASE button

Provides a dry closure contact for each entrance. Activates door strike at communicating entrance station, activated for an adjustable duration.

Call tone cutout indicator

Supplementary Station within an apartment



Maximum Capacity of Five Entrance Stations and 100 ~150(*) Apartment Stations

(*) Depends on a system configuration

re Bus

This is all what you need

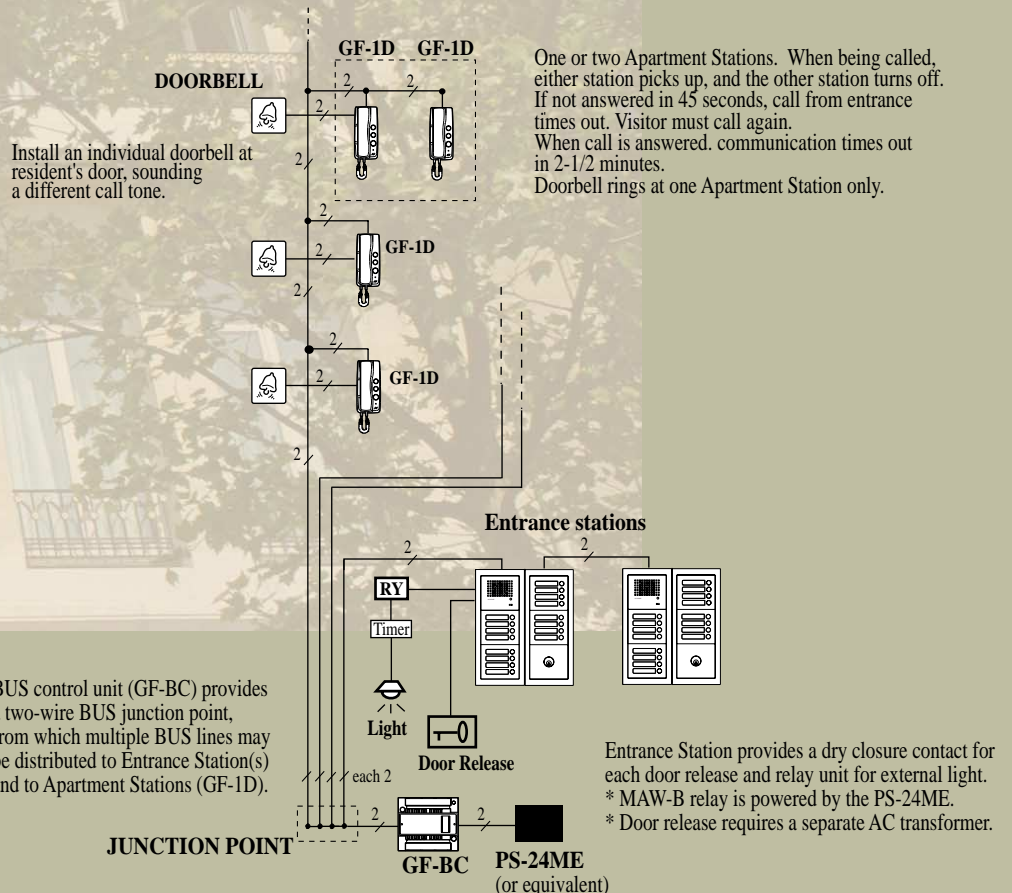

Fully Modular Entrance Stations with up to 100-Call Capacity

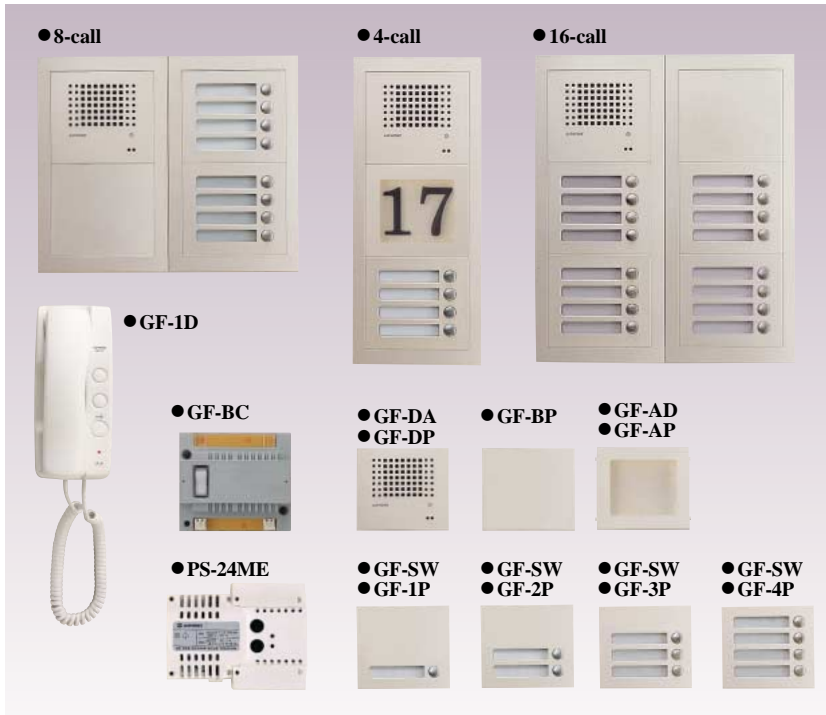

SYSTEM COMPONENTS

- **Apartment Station**
GF-1D Apartment station, handset
- **Control unit**
GF-BC BUS control unit
PS-24ME Power supply (or equivalent)
- **Entrance Station Modules**
GF-DA Speech module, entrance station
GF-DP Panel only for GF-DA
GF-SW 4-call switch module
GF-4P Panel only, 4-call
GF-3P Panel only, 3-call
GF-2P Panel only, 2-call
GF-1P Panel only, 1-call
GF-BP Blank panel
GF-AD Address module
GF-AP Panel only for GF-AD
- GF-2F 2-module front frame & bracket
GF-3F 3-module front frame & bracket
GF-2B Built-in back box for 2 modules
GF-3B Built-in back box for 3 modules
GF-H Hood

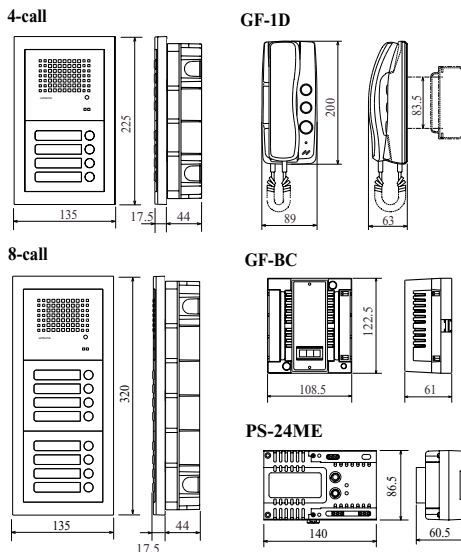

	SPEECH	CALL SWITCH				BLANK PANEL	ADDRESS	FRAME & BRACKET		BACK BOX	
		1-call	2-call	3-call	4-call			0-call	GF-AD	GF-AP	GF-2F
	GF-DA GF-DP	GF-SW GF-1P	GF-SW GF-2P	GF-SW GF-3P	GF-SW GF-4P	GF-BP	GF-AD GF-AP	GF-2F	GF-3F	GF-2B	GF-3B
1-call	1	1	-	-	-	-	-	1	-	1	-
2-call	1	-	1	-	-	-	-	1	-	1	-
3-call	1	-	-	1	-	-	-	1	-	1	-
4-call	1	-	-	-	1	-	-	1	-	1	-
5-call	1	1	-	-	1	-	-	-	1	-	1
6-call	1	-	1	-	1	-	-	-	1	-	1
7-call	1	-	-	1	1	-	-	-	1	-	1
8-call	1	-	-	-	2	-	-	-	1	-	1
9-call	1	1	-	-	2	-	-	2	-	2	-
10-call	1	-	1	-	2	-	-	2	-	2	-
20-call	1	-	-	-	5	-	-	-	2	-	2
30-call	1	-	1	-	7	-	-	-	3	-	3
40-call	1	-	-	-	10	1	-	-	4	-	4
50-call	1	-	1	-	12	1	-	-	5	-	5

SPECIFICATIONS

- Power source: 24V DC, 0.9A
- Calling: Call tone from Entrance Station distinguishable from an individual doorbell.
- Communication: Simultaneous with handset.
- Talk channel: Single channel, non-open
- Wiring: 2 wires BUS lines, throughout system.
- Cable: Specified SYTI or the equivalent.
- Wiring distance :

	Between	0.8mmφ
● BUS control unit ~ Junction point		5m
● Power supply ~ BUS control unit		5m
● Junction ~ Entrance station		300m
● Junction ~ Apartment station (farthest)		300m
● Total wiring distance		2,500m

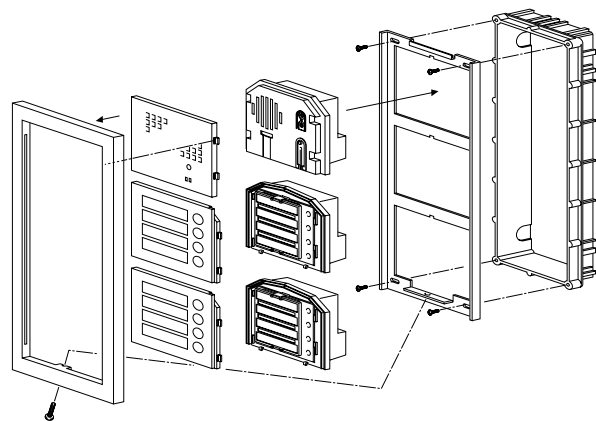

Distributed by :



Nagoya, Japan
<http://www.aiphone.co.jp>